

Front room floorplan without pedestals

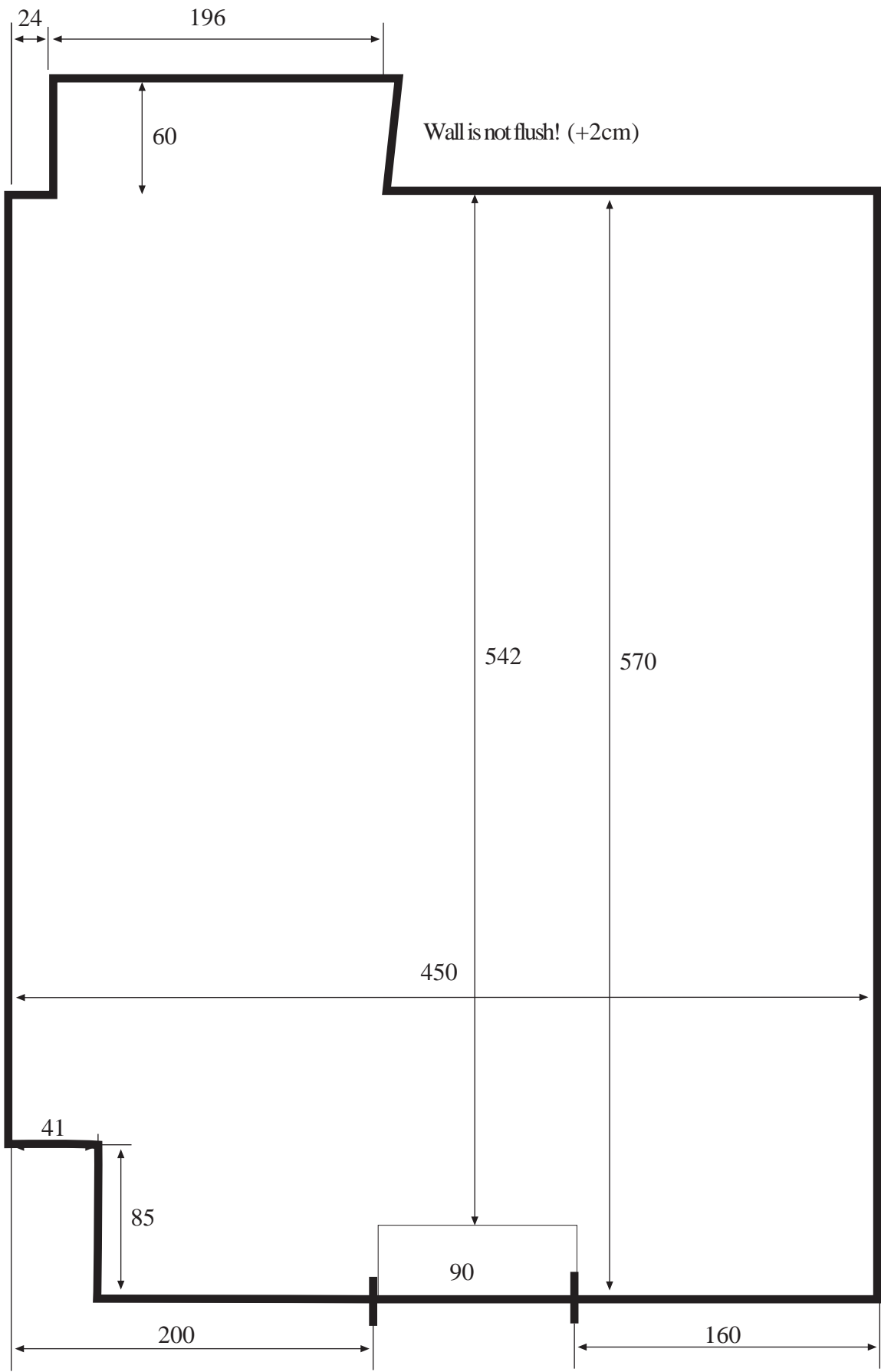

# Window Wall

450

70 + Lintel

39

200

90

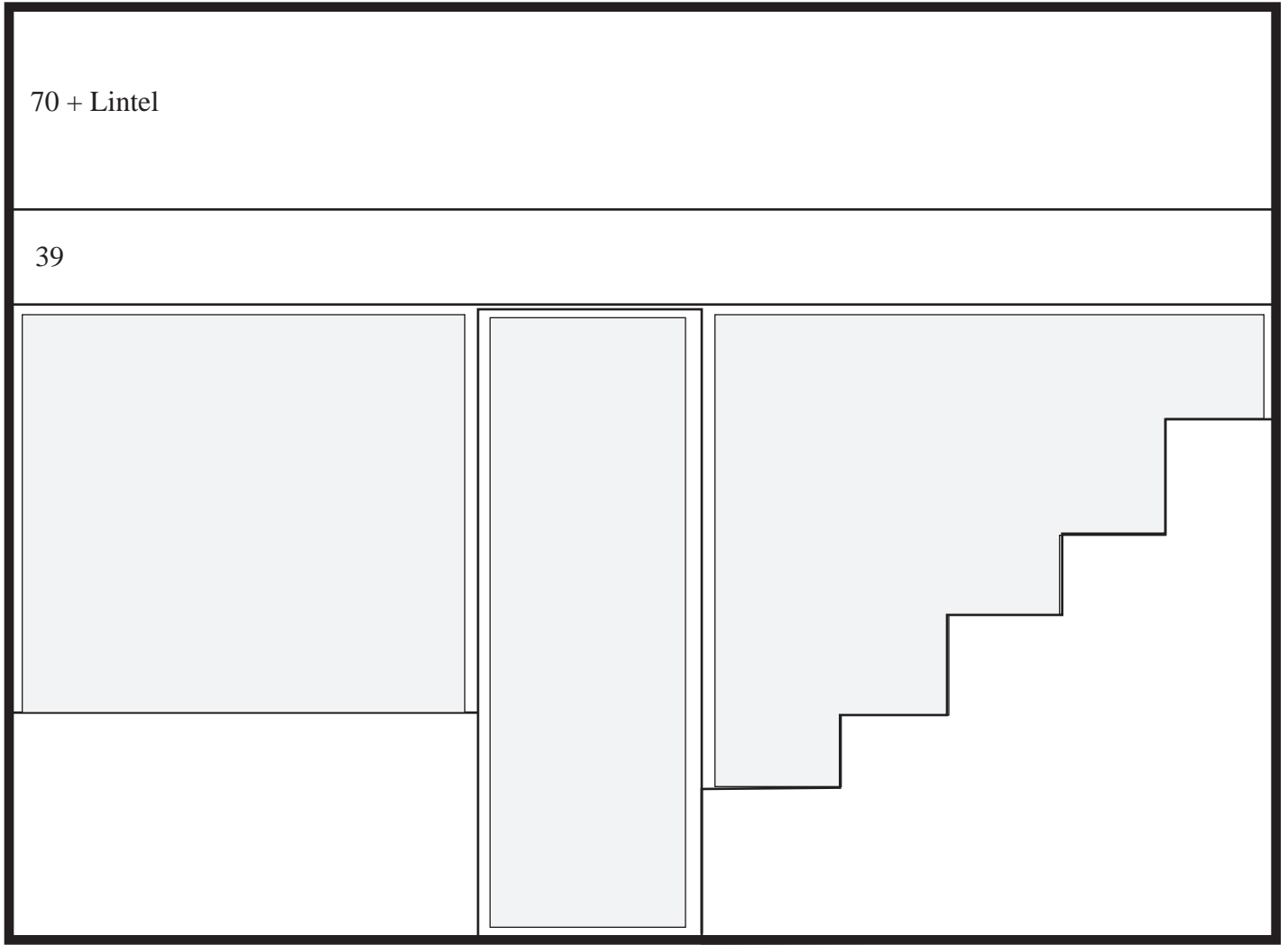

Left Wall

570

330

96

120

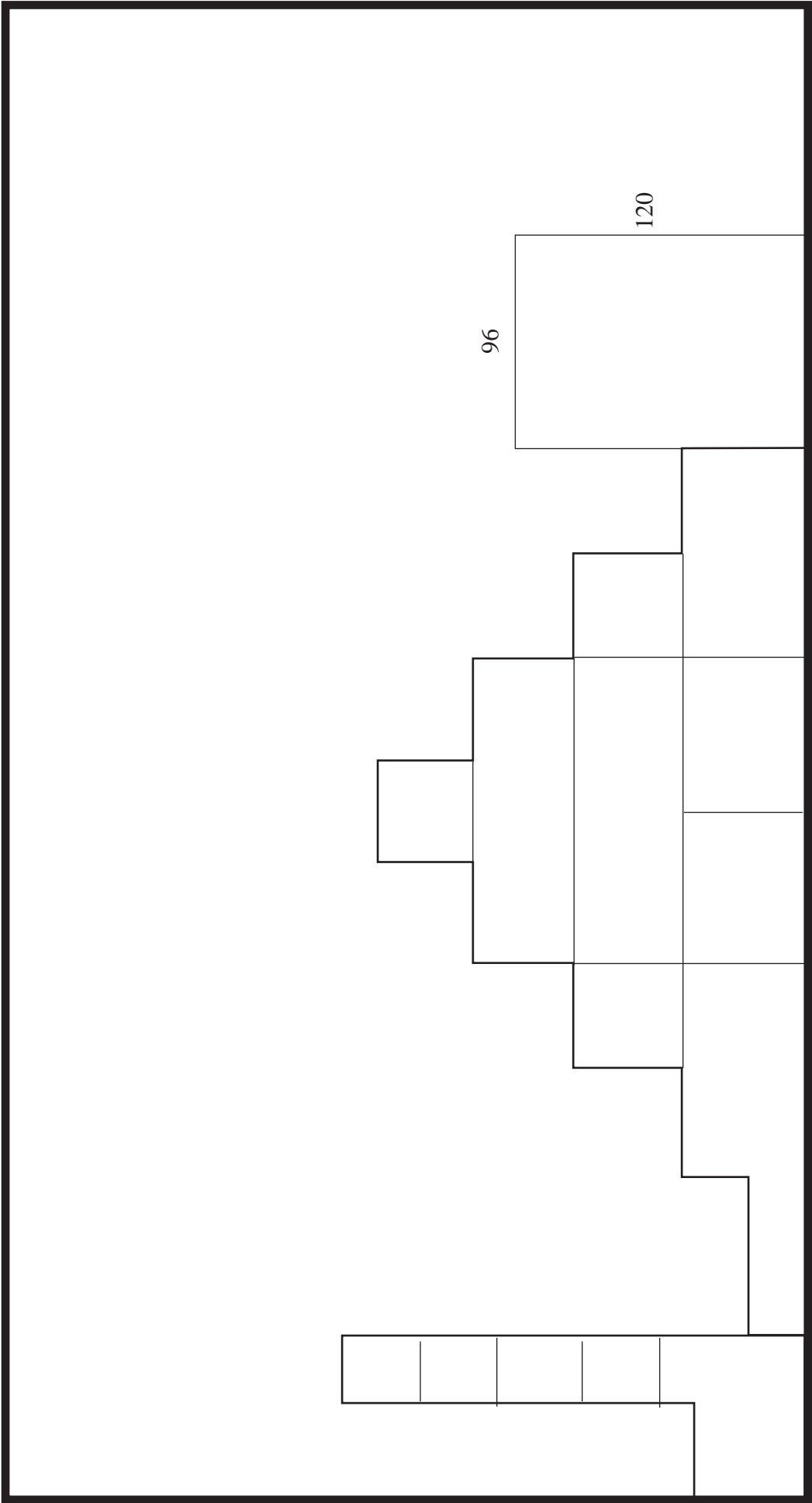

Right Wall

570

330

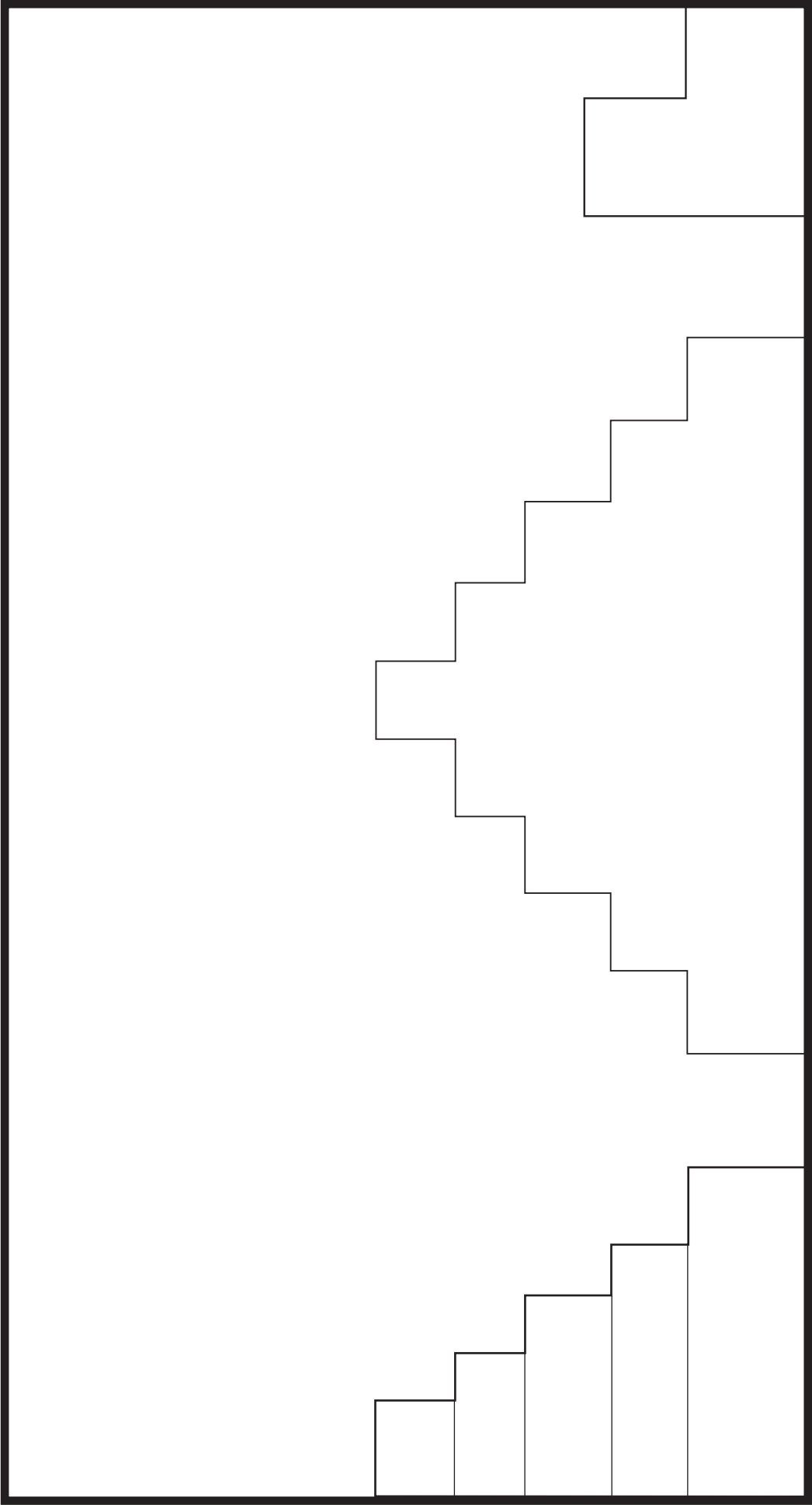

Door Wall

450



Front room floorplan with pedestals

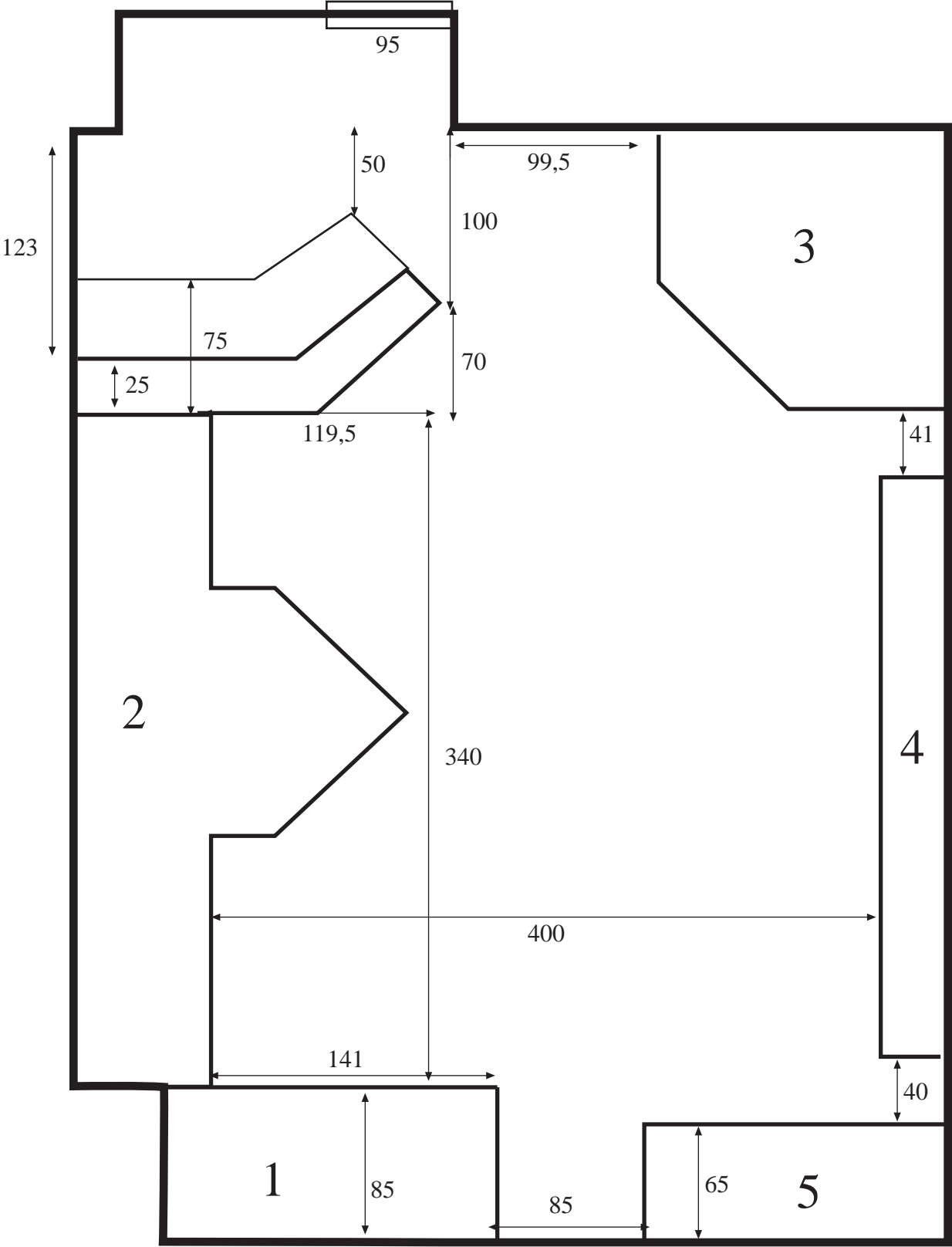

# Pedestal 1

Distance to ceiling 160

Cross Section

Window  
side

Room  
side

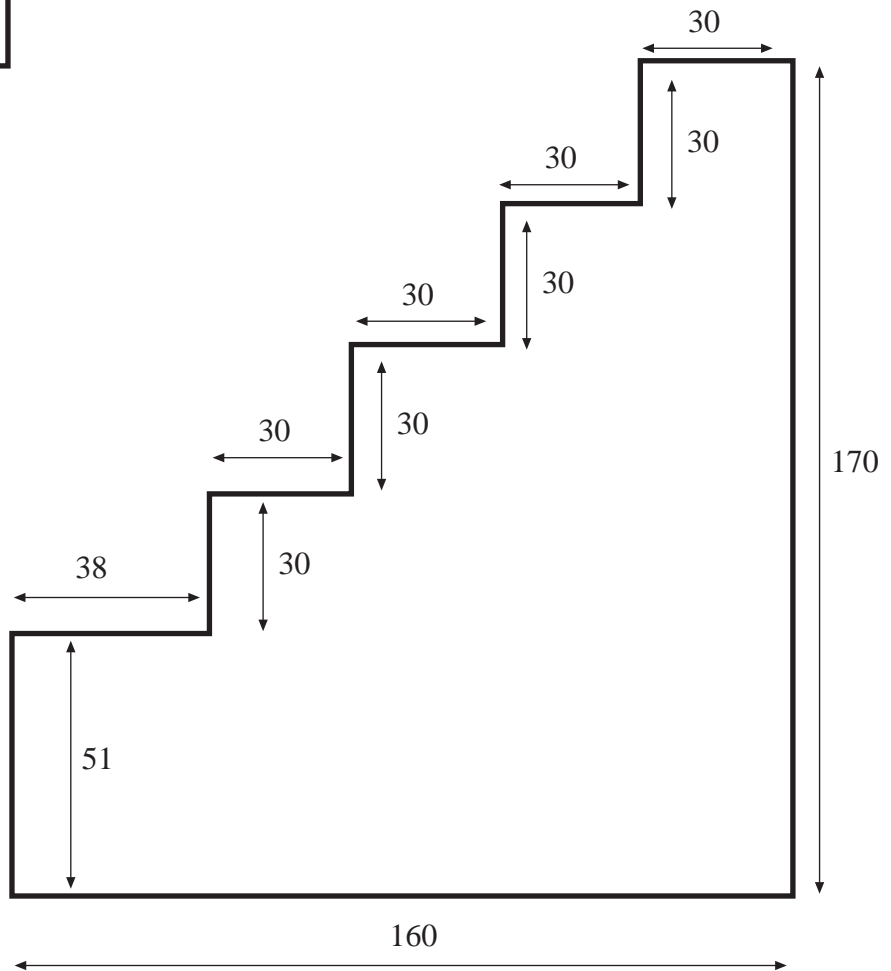
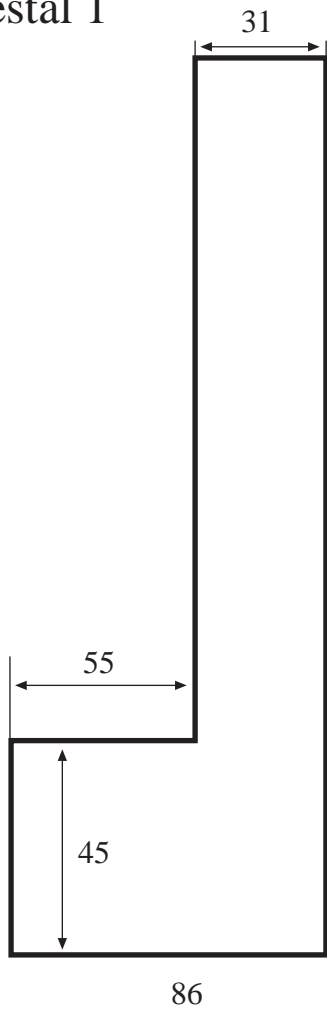

From the room looking out

# Pedestal 2/ Page 1

Distance to ceiling 170

frontal view

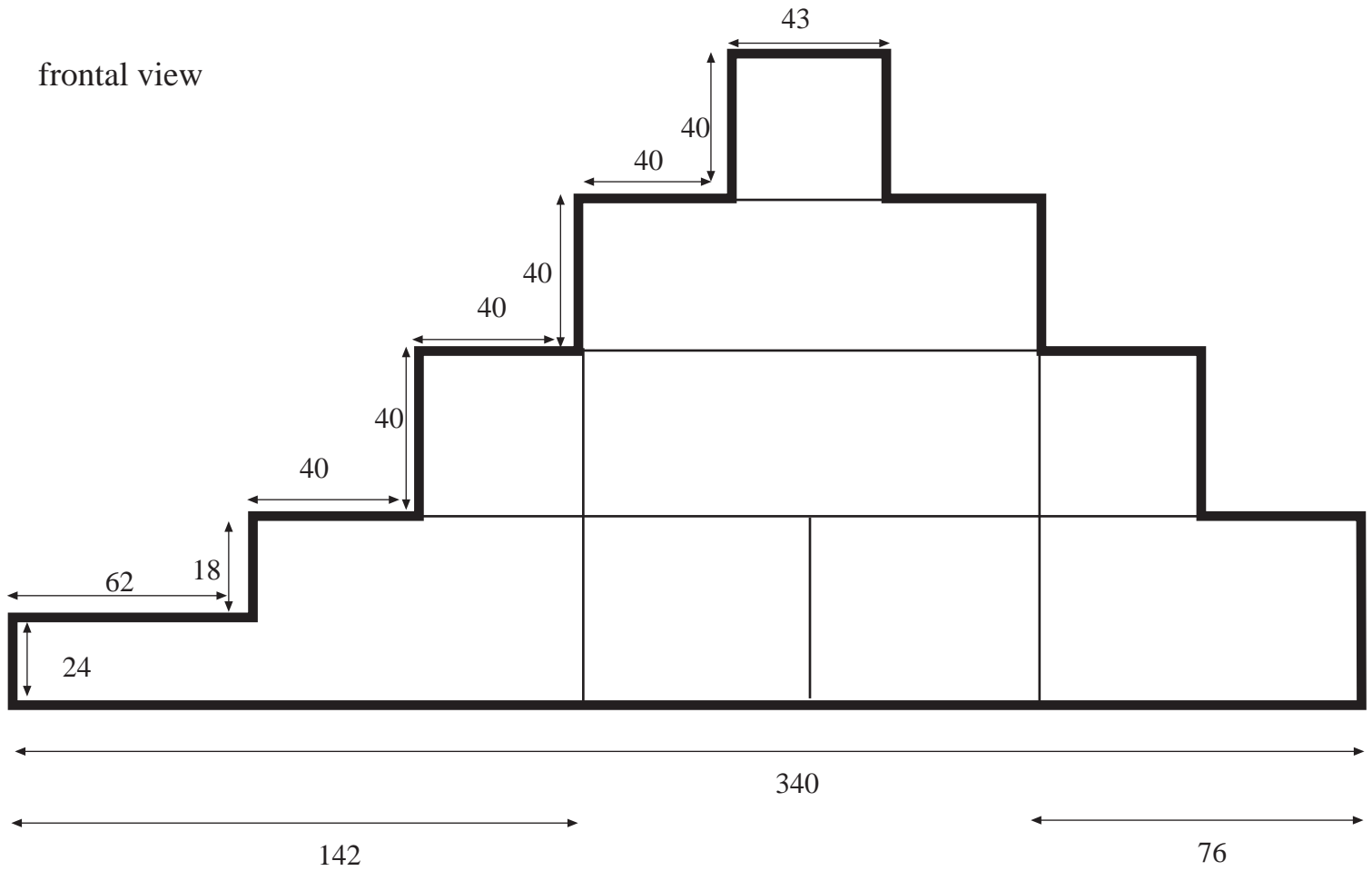

from above

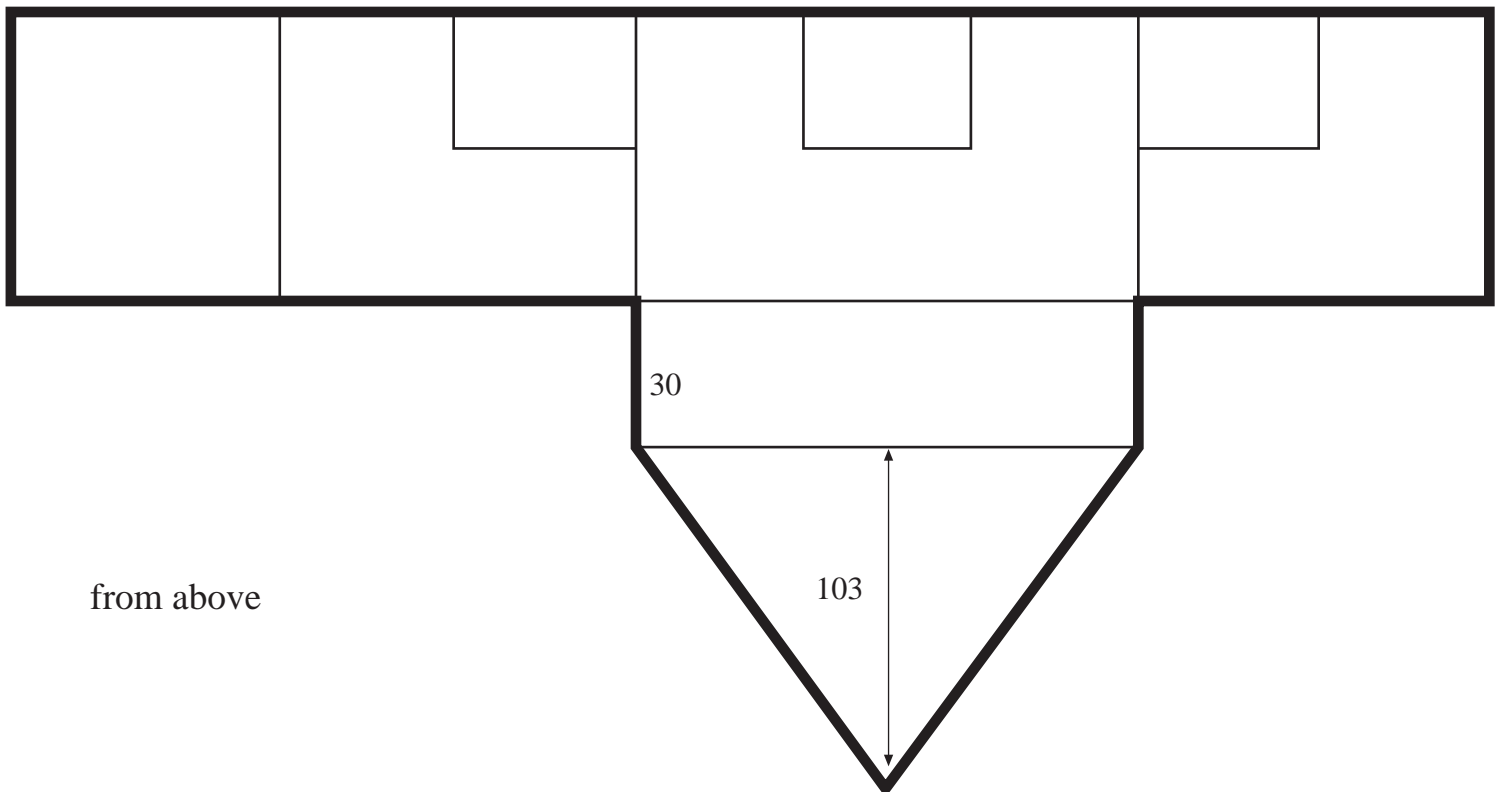

# Pedestal 2/ Page 2

Distance to ceiling 170

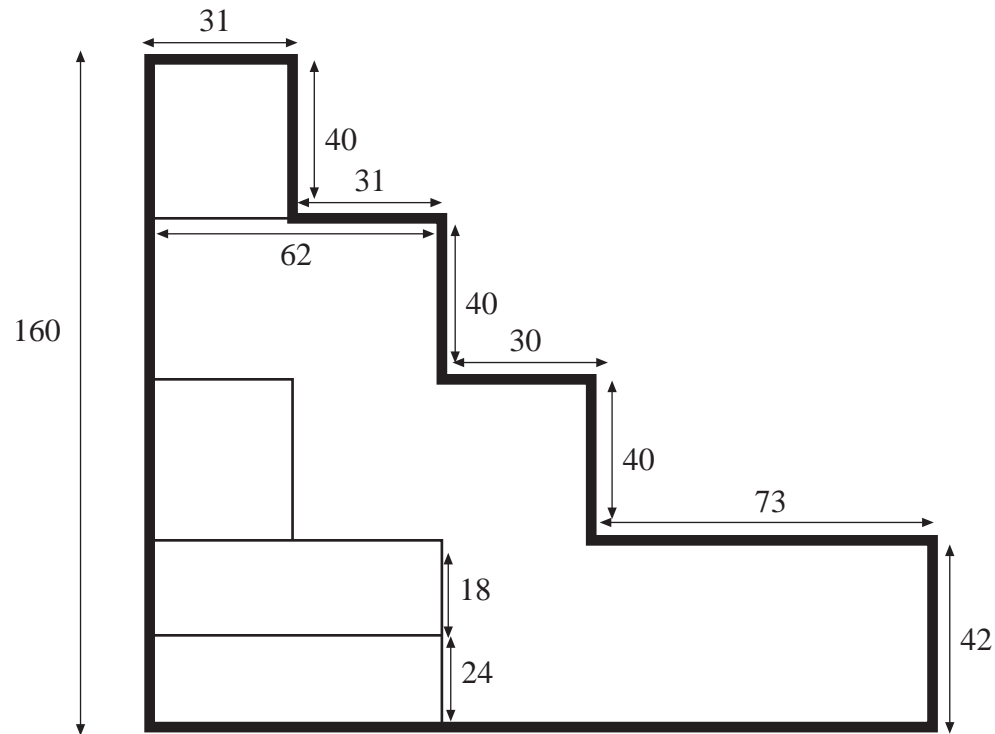

Cross Section

Pedestal 3

Distance to ceiling 170

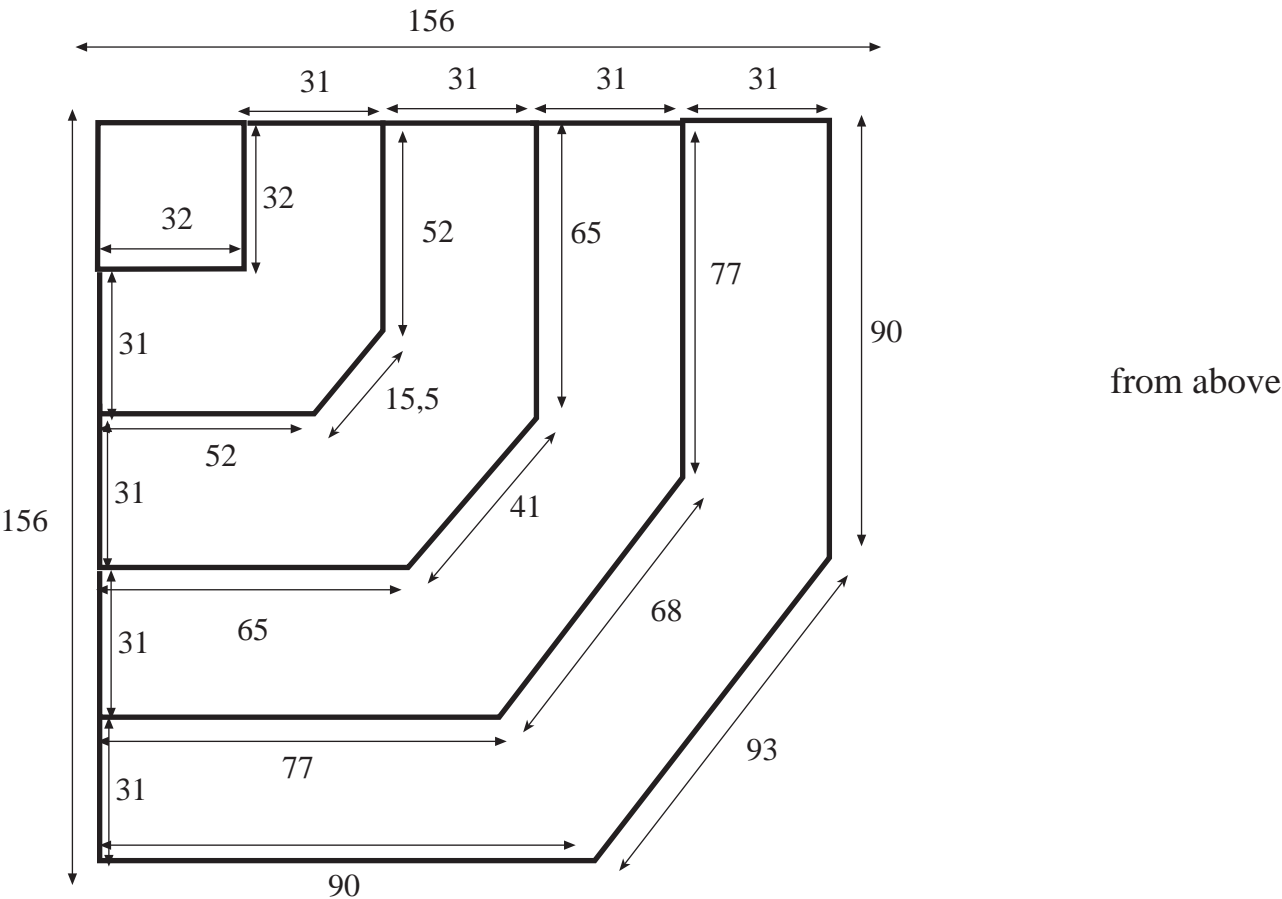
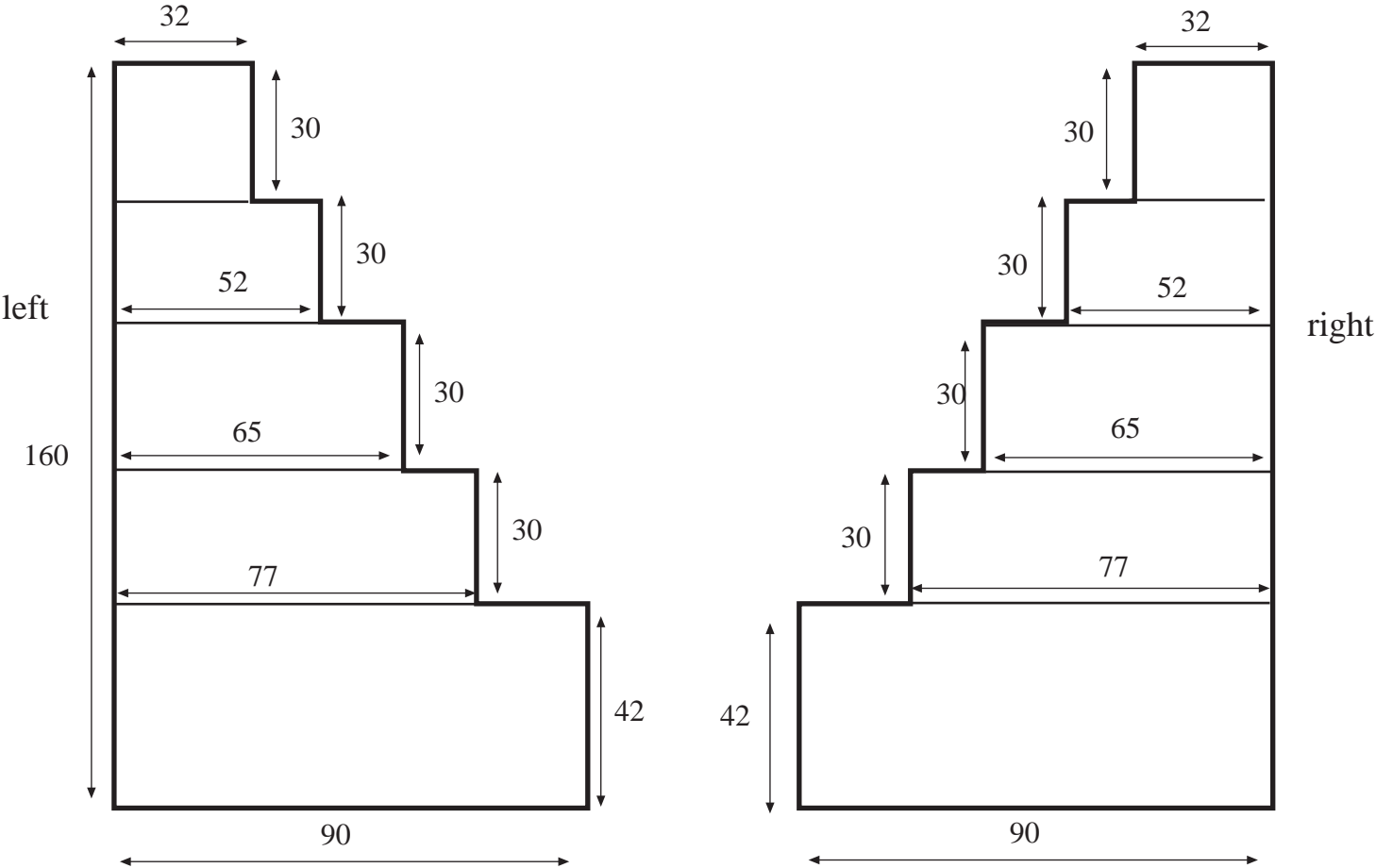

# Pedestal 4

32 deep

Distance to ceiling 170

Front

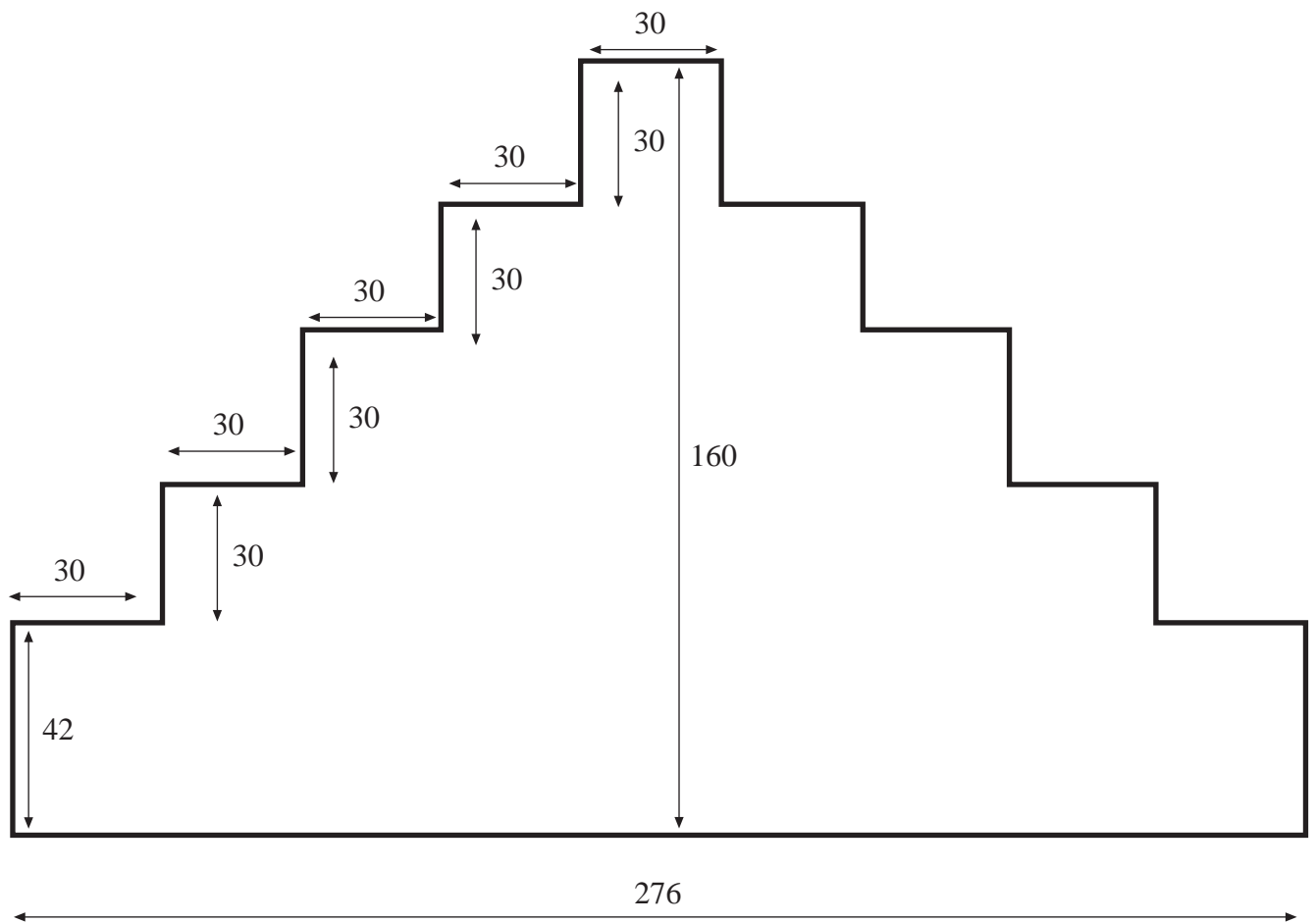

Pedestal 5

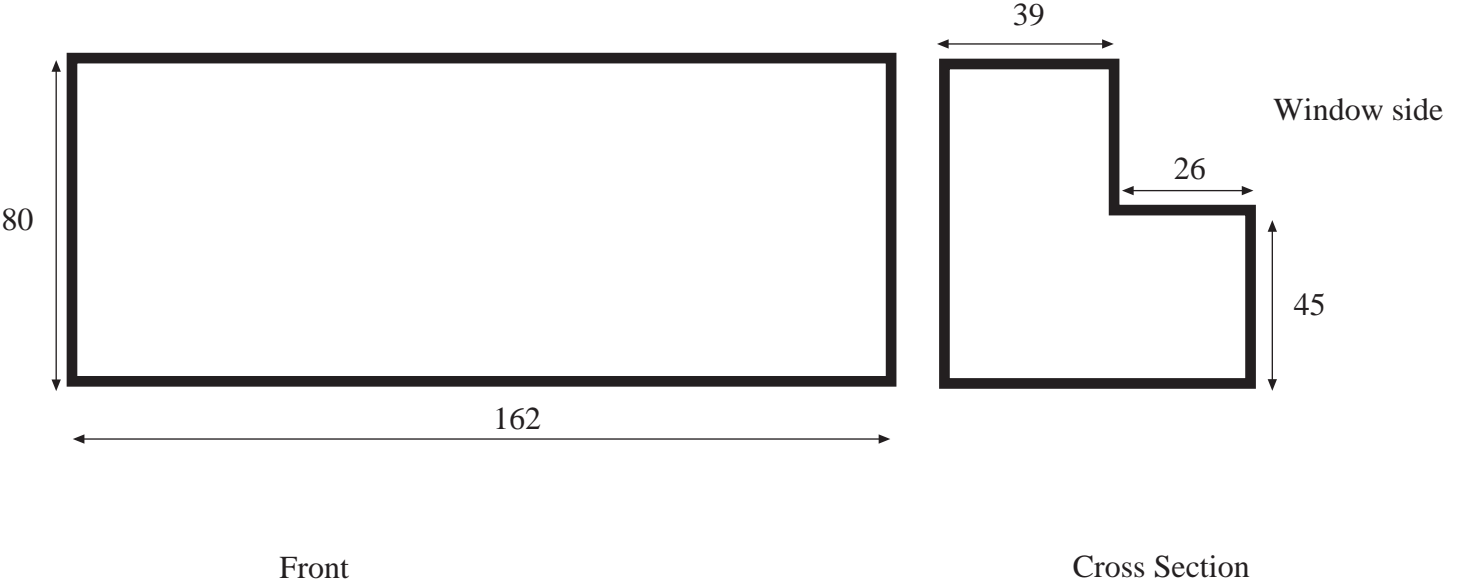

# Corridor

Length 148  
Width 112  
Height 310

# Back Room

Length 370  
Width 220  
Height 310

Wall = Rough Bricks

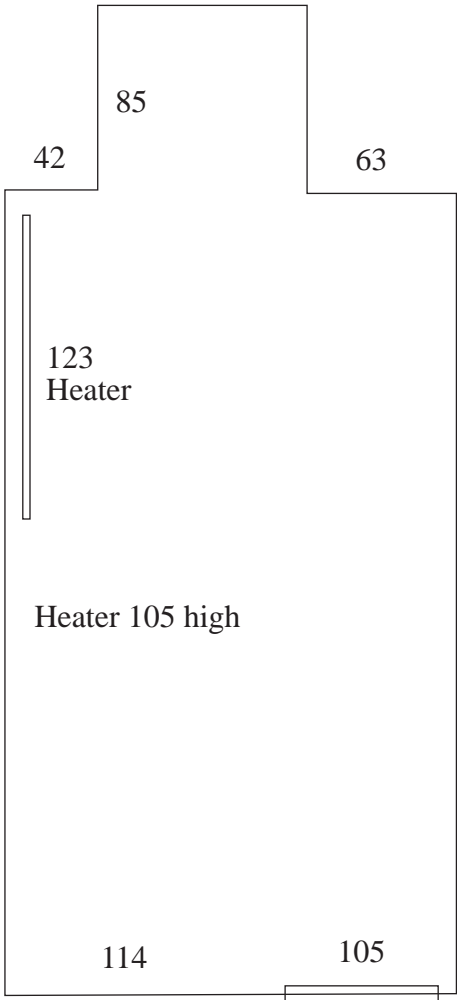

back corner (exit)

